

TURBINE AIRCRAFT BATTERY

RG-380E/53GH Specifications

Voltage	24 Volts
Rated Capacity C ₁	53 AH
Maximum Weight	97.4 LB / 44.2 KG

Specifications are subject to change without notice

**IEC 0.03 Second Power Rating (IPP)
 & 15 Second Power Rating (IPR)**

IPP	IPR	IPP	IPR	IPP	IPR
At 23° C (74° F)		At -18° C (0° F)		At -30° C (-22° F)	
1650 A	1200 A	1325 A	1000 A	1125 A	800 A

Rated in accordance with RTCA DO-293A & IEC 60952-1

ISO 9001 + AS9100

The data/information contained herein has been reviewed & approved for general release on the basis that this document contains no export controlled information.

Other Part Number Specs listed on back.

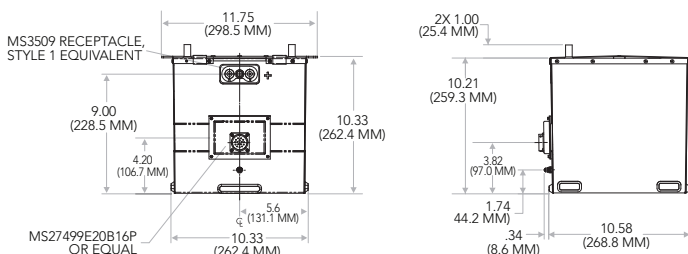

Concorde's superior Platinum Series® batteries have been proven reliable, durable and safe in turbine aircraft applications since 1977. Concorde's valve regulated sealed recombinant gas (RG®) Turbine Starting aircraft batteries are constructed with advanced lead acid, absorbed glass mat (AGM) technology.

- Dual Purpose – Emergency or main starting
- Emergency Power - Reliable essential power in the event of a generator failure
- 100% Factory Tested – C₁ and high rate performance tested prior to shipment assures airworthiness & installation readiness
- Low impedance design – Unique design features reduce internal resistance
- Maintenance Free – No water replenishment is required – ever
- Proprietary PolyGuard® Separators – Added protection against shock & vibration
- Proven Technology – Dependable, durable and safe
- Quick Disconnect – MIL-PRF - 18148/3
- Safe – No threat of thermal runaway & no deep cycling
- Starting Power – Superior starting power in hot & cold climates
- Transport – Ship Hazmat Exempt whether by land, sea or air
- FAA PMA and TSO-C173a approved
- Worldwide – Available through a professional network of worldwide distributors

Concorde designs and manufactures over 90 models of Original Equipment and direct replacement batteries for fixed wing and rotary aircraft and has a reputation for designing application specific solutions. Concorde batteries are installed as Original Equipment by the majority of aircraft manufacturers and adopted by military aircraft operators worldwide.

Manufacturing certified aircraft batteries for over 40 years: Military, TSO, FAA-PMA, OEM

RG-380E/GH Series

TURBINE AIRCRAFT BATTERY

RG-380E/60GH Specifications

Voltage	24 Volts
Rated Capacity C ₁	48 AH
Maximum Weight	96.4 LB / 43.7 KG

Specifications are subject to change without notice

**IEC 0.03 Second Power Rating (IPP)
 & 15 Second Power Rating (IPR)**

IPP	IPR	IPP	IPR	IPP	IPR
At 23° C (74° F)		At -18° C (0° F)		At -30° C (-22° F)	
1600 A	1200 A	1200 A	950 A	900 A	700 A

Rated in accordance with RTCA DO-293A & IEC 60952-1

RG-380E/44GH Specifications

Voltage	24 Volts
Rated Capacity C ₁	42 AH
Maximum Weight	89.4 LB / 40.6 KG

Specifications are subject to change without notice

**IEC 0.03 Second Power Rating (IPP)
 & 15 Second Power Rating (IPR)**

IPP	IPR	IPP	IPR	IPP	IPR
At 23° C (74° F)		At -18° C (0° F)		At -30° C (-22° F)	
1350 A	1000 A	875 A	750 A	750 A	600 A

Rated in accordance with RTCA DO-293A & IEC 60952-1

RG-380E/46GH Specifications

Voltage	24 Volts
Rated Capacity C ₁	46 AH
Maximum Weight	89.4 LB / 40.6 KG

Specifications are subject to change without notice

**IEC 0.03 Second Power Rating (IPP)
 & 15 Second Power Rating (IPR)**

IPP	IPR	IPP	IPR	IPP	IPR
At 23° C (74° F)		At -18° C (0° F)		At -30° C (-22° F)	
1375 A	1050 A	1075 A	850 A	875 A	675 A

Rated in accordance with RTCA DO-293A & IEC 60952-1

RG-380E/40GH Specifications

Voltage	24 Volts
Rated Capacity C ₁	38 AH
Maximum Weight	84.4 LB / 38.3 KG

Specifications are subject to change without notice

**IEC 0.03 Second Power Rating (IPP)
 & 15 Second Power Rating (IPR)**

IPP	IPR	IPP	IPR	IPP	IPR
At 23° C (74° F)		At -18° C (0° F)		At -30° C (-22° F)	
1350 A	1050 A	900 A	750 A	650 A	550 A

Rated in accordance with RTCA DO-293A & IEC 60952-1